

Flanged as B16.1 Class 125 is widely used in American standard fire valve production and installation.

Available size of Class 125

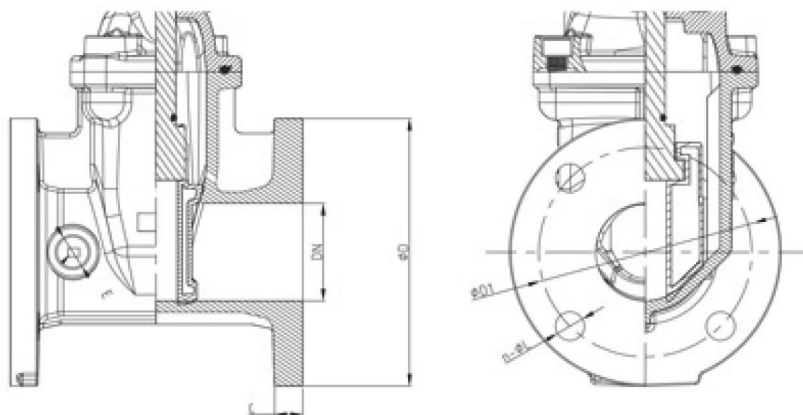

Size	Flange dimension (mm)		Bolting			
	D	C (min)	D1 (PCD)	D. of bolt hole	Bolt no.	Bolt size
2" / DN50 / 60.3mm	152	16.0	120.7	3/4"	4	5/8"
2-1/2" / DN65 / 73.0mm	178	17.5	139.7	3/4"	4	5/8"
3" / DN80 / 88.9mm	191	19.1	152.4	3/4"	4	5/8"
4" / DN100 / 114.3mm	229	19.1	190.5	3/4"	8	5/8"
5" / DN125 / 141.3mm	254	19.1	215.9	7/8"	8	3/4"
6" / DN150 / 168.3mm	279	19.1	241.3	7/8"	8	3/4"
8" / DN200 / 219.1mm	343	22.2	298.5	7/8"	8	3/4"
10" / DN250 / 273.0mm	406	23.8	362	1"	12	7/8"
12" / DN300 / 323.8mm	483	25.4	431.8	1"	12	7/8"
14" / DN350 / 355.6mm	533	25.4	476.3	1-1/8"	12	1"
16" / DN400 / 406.4mm	597	25.4	539.8	1-1/8"	16	1"
18" / DN450 / 457mm	635	25.4	577.9	1-1/4"	16	1-1/8"
20" / DN500 / 508mm	699	28.6	635	1-1/4"	20	1-1/8"
24" / DN600 / 610mm	813	30.1	749.3	1-3/8"	20	1-1/4"

Note:

1. For flange diameter, it follows table I-9 of ASME B16.1 and are multiplied by 25.4 to get SI unit.
2. For flange thickness, it follows AWWA C515, not as ASME B16.1.
3. For flange facing, it is flat faced and finished in accordance with MSS SP-6.